

PROFESSIONAL | RESPONSIBLE | EXTREME

FITTING EXPORT GROUP

PRODUCT MANUAL

AVB

FITTING EXPORT GROUP



EMAIL: FITTINGEXPORTGROUP@GMAIL.COM

保定瓦勒布朗进出口贸易有限公司
BAODING VALVULA IMP&EXP TRADING CO., LTD

BS 5163 GATE VALVE PN16

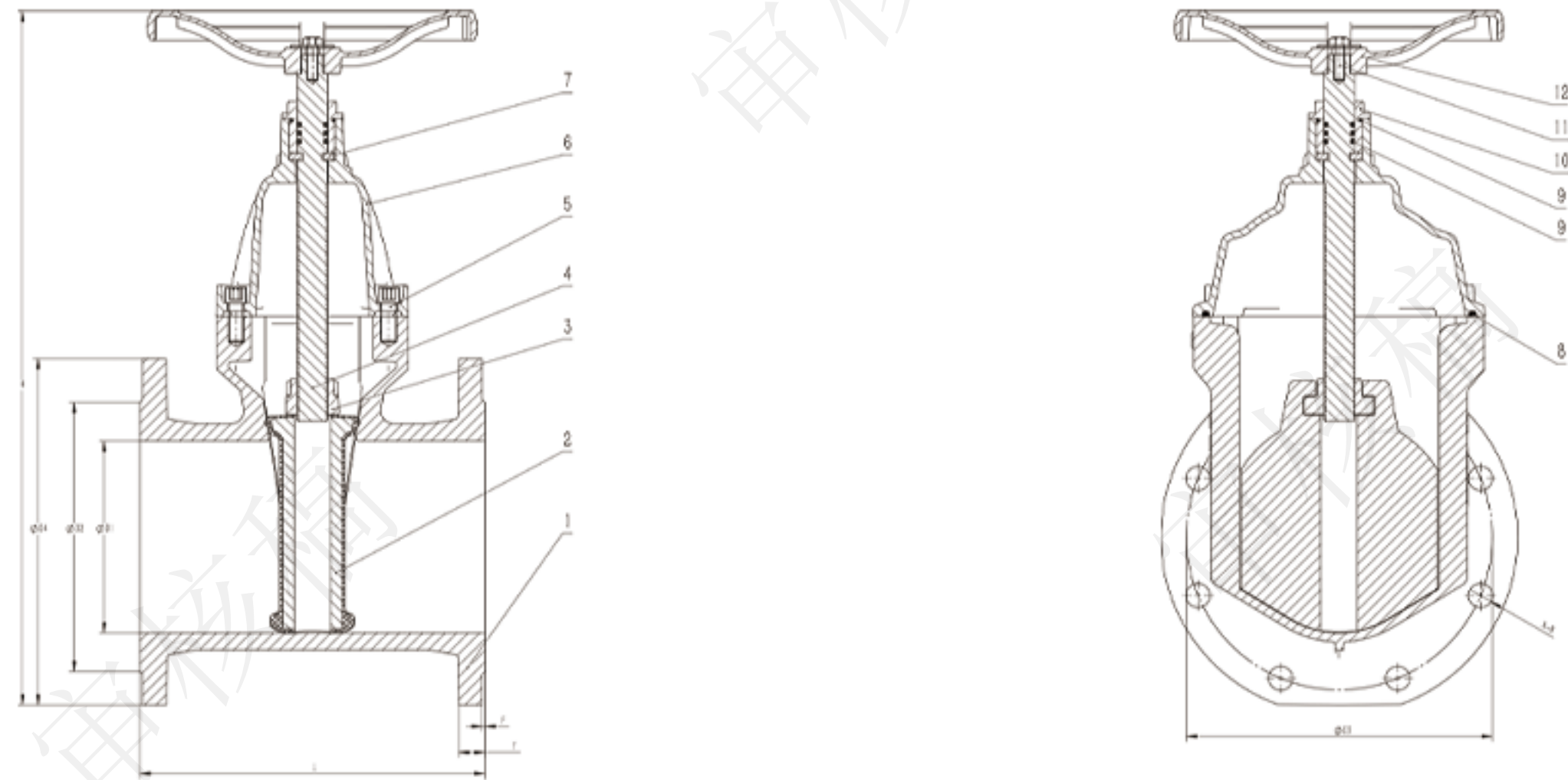

DN	L	H	D1	D4	D3	X-H	T	F	D2
50	178	241	50	165	125	4-019	16.5	2	99
65	190	270	65	185	145	4-019	17	2	118
80	203	222	80	200	160	4-019 8-019	19	3	132
100	229	333	100	220	180	8-019	20	3	156
125	254	384	125	250	210	8-019	20	3	184
150	267	420	150	285	240	8-023	20	3	211
200	292	512	200	340	295	8-023 12-023	20	3	266
250	330	602	250	405	350 355	12-023 12-026	25	3	319
300	356	705	300	460	400 410	12-023 12-026	28	4	370
350	381	782	350	520	460 470	16-023 16-026	28	4	430
400	406	880	400	582	515 525	16-025 16-030	28	4	475
450	432	1000	450	615 640	565 585	20-026 20-030	32	4	565 585
500	457	1055	500	670 715	620 650	20-026 20-030	32	4	580
600	508	1260	600	780 840	725 700	20-030 24-036	38	4	680
700	610	2050	700	895 910	840	24-030 24-036	40	5	800 793
800	665	2110	800	1015 1025	950	24-033 24-040	44	5	905 900

Item	Part Name	Material
1	Body	GGG40
2	Disc	GGG40+EPDM
3	Stem Nut	Brass
4	Stem	SS420
5	Bolt	Garbon Steel
6	Bonnet	GGG40
7	Holding Ring	Brass
8	Bonnet Gasket	EPDM
9	"O"Ring	Silica Gel
10	Stem Nut	Brass
11	Bolt	SS201
12	Handwheel	Ductileiron



BS 5163 GATE VALVE PN10/16

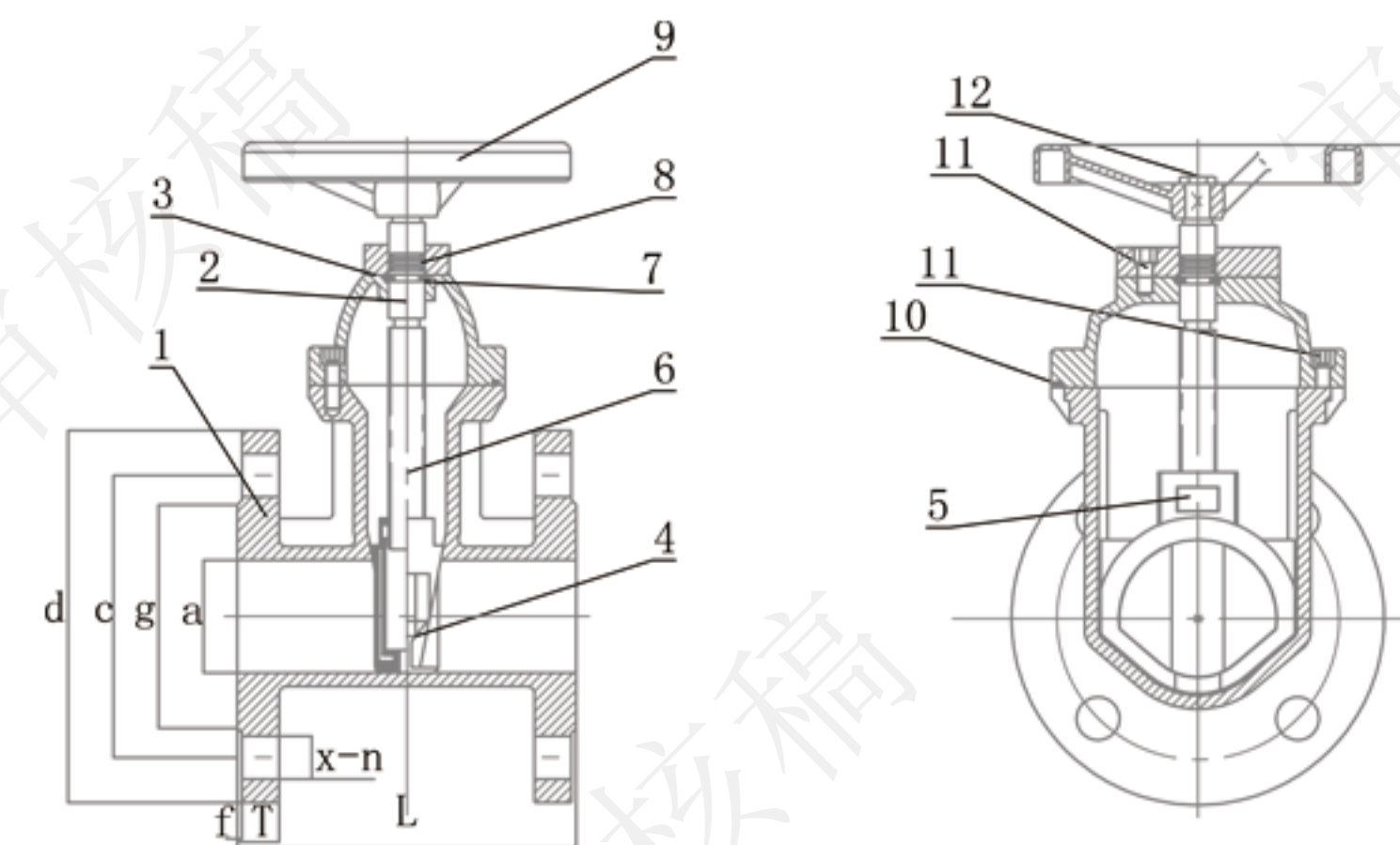

Item	Part Name	Material
1	Body	GGG50
2	Bonnet	GGG50
3	Sealing Ring	GGG50
4	Disc	GGG50+EPDM
5	Stem Nut	DI
6	Stem	SS420
7	Holding Ring	WCB
8	"O"Ring	Silica Gel
9	Handwheel	Carbon Steel
10	Bonnet Gasket	EPDM
11	Bolt	Carbon Steel
12	Bolt	SS

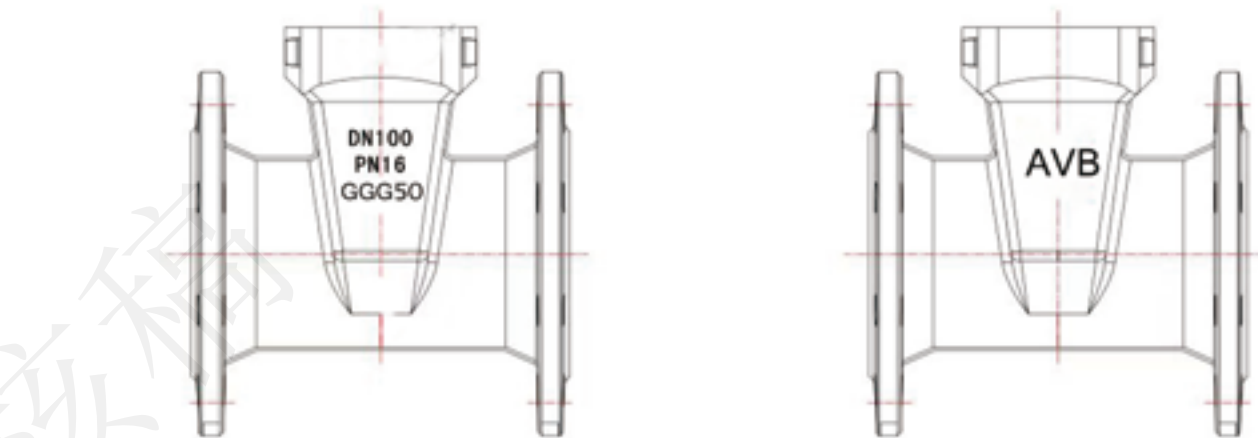

Properties of products		
Rated operating pressure	PN	1.0/1.6MPa
Test pressure	intnsion	1.5/2.4MPa
	Hermetic	1.1/1.76MPa
Working Temperature	T	≤80℃
Applicable Mendium		Water

DN	L	H	D1	D4	D3	X-H	T	F	0g	Kg
50	178	241	50	165	125	4-019	16.5	2	99	8
65	190	270	65	185	145	4-019	17	2	118	10
80	203	222	80	200	160	4-019 8-019	19	3	132	12
100	229	333	100	220	180	8-019	20	3	156	15.5
125	254	384	125	250	210	8-019	20	3	184	24
150	267	420	150	285	240	8-023	20	3	211	29.5
200	292	512	200	340	295	8-023 12-023	20	3	266	50
250	330	602	250	405	350 355	12-023 12-026	25	3	319	69
300	356	705	300	460	400 410	12-023 12-026	28	4	370	96
350	381	782	350	520	460 470	16-023 16-026	28	4	430	148
400	406	880	400	582	515 525	16-025 16-030	28	4	475	200
450	432	1000	450	615 640	565 585	20-026 20-030	32	4	565 585	246
500	457	1055	500	670 715	620 650	20-026 20-030	32	4	580	350 370
600	508	1260	600	780 840	725 700	20-030 24-036	38	4	680	470 490
700	610	2050	700	895 910	840	24-030 24-036	40	5	800 793	
800	665	2110	800	1015 1025	950	24-033 24-040	44	5	905 900	

BS 5163 GATE VALVE PN16

DN	L	D	C	x-n	T
50	175	153	125	4*18	14
65	190	175	145	4*18	16
80	204	189	160	8*18	16
100	233	213	180	8*18	17
125	252	240	210	8*18	17
150	262	275	240	8*23	17
200	292	334	295	12*23	20
250	330	405	355	12*25	25
300	256	460	410	12*25	25

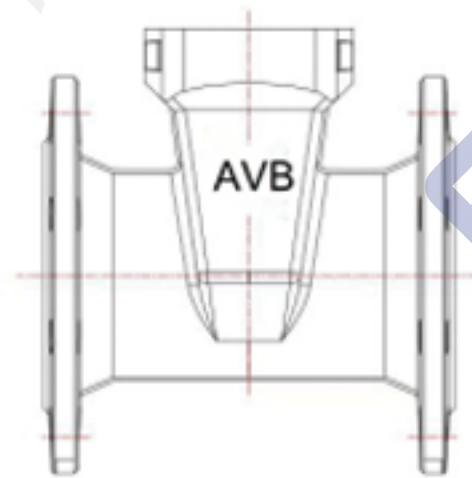

Properties of products		
Rated operating pressure	PN	1.0/1.6MPa
Test pressure	intnsion	1.5/2.4MPa
	Hermetic	1.1/1.76MPa
Working Temperature	T	≤80°C
Applicable Medium		Water

Item	Part Name	Material
1	Body	GGG50
2	Bonnet	GGG50
3	Sealing Ring	GGG50
4	Disc	GGG50+EPDM
5	Stem Nut	DI
6	Stem	WCB
7	Holding Ring	WCB
8	"O"Ring	Silica Gel
9	Handwheel	Carbon Steel
10	Bonnet Gasket	EPDM
11	Bolt	Carbon Steel
12	Bolt	Carbon Steel

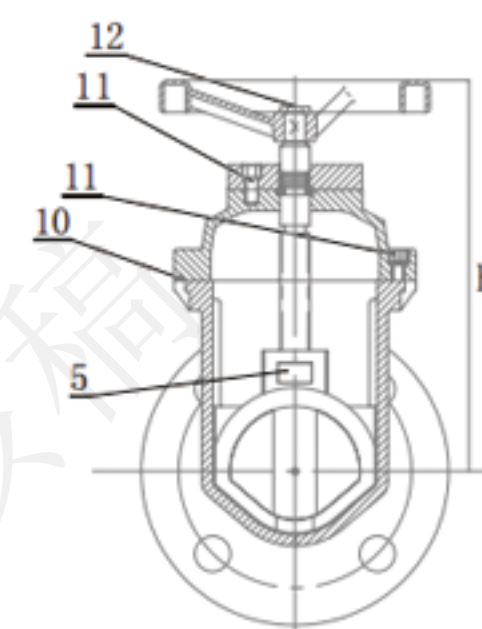
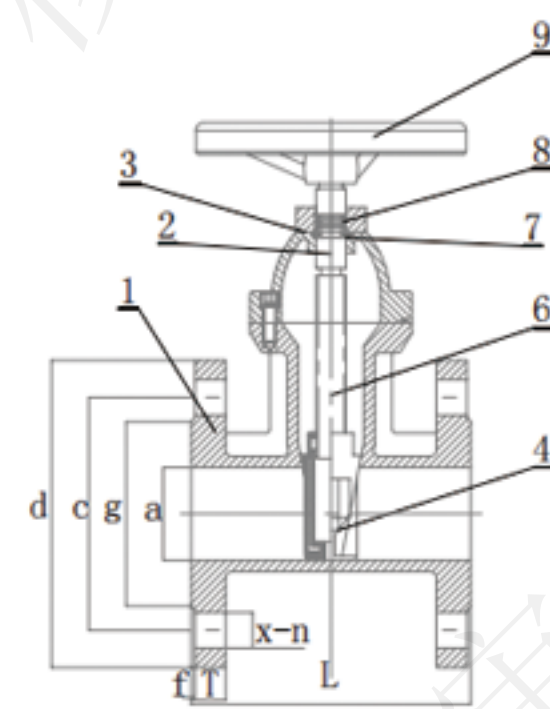

BUTTERFLY VALVE STAINLESS STEEL PN16

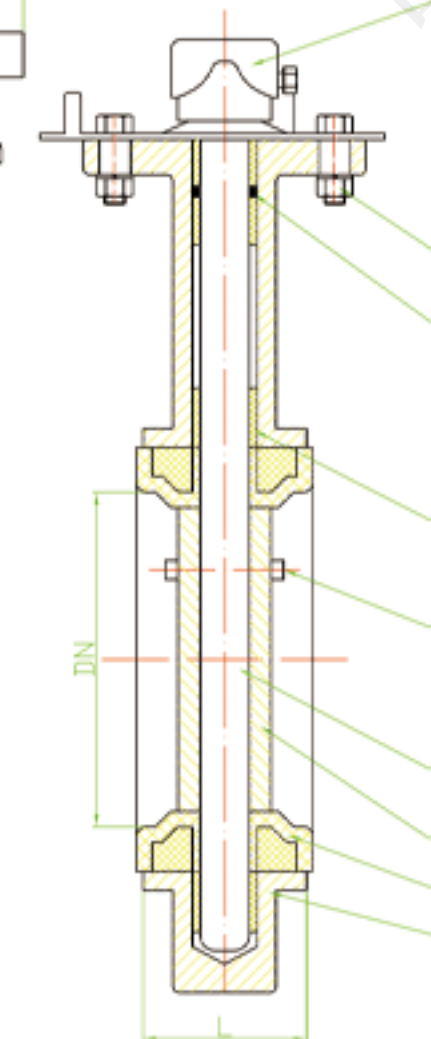
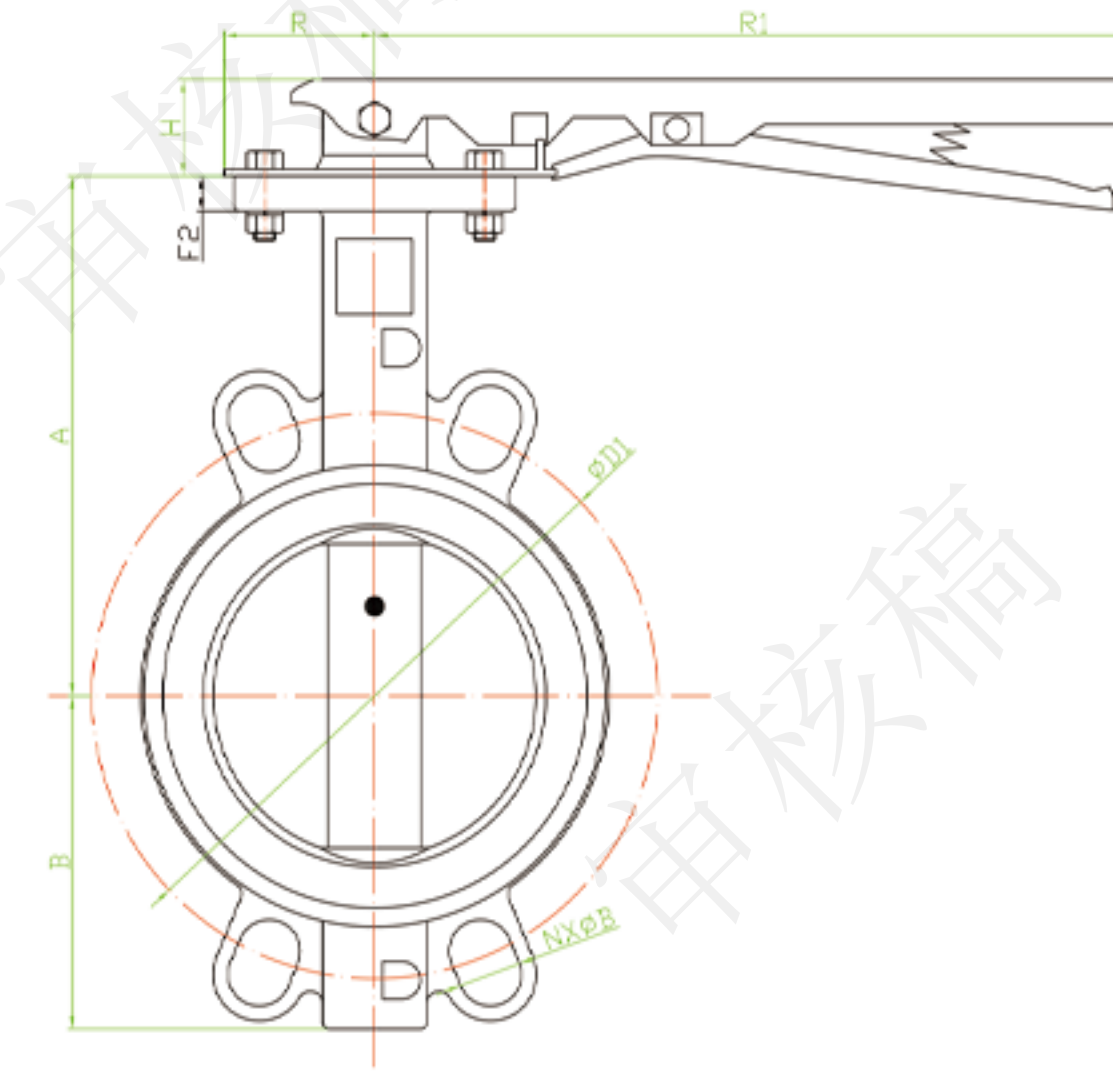

DN	A	B	H	F2	L	ØD1	NXØB	R	R1
DN40	131	70	28	10	42	110	4X18	45	220
DN50	131	70	28	10	42	125	4X18	45	220
DN65	138	76	28	10	44.5	145	4X18	45	220
DN80	145	94	28	10	44.5	160	4 (8) X18	45	220
DN100	166	105	32	12	51	180	4 (8) X18	50	220
DN125	189	118	32	12	54.5	210	4 (8) X18	50	256
DN150	206	138	32	14	54.5	240	4 (8) X22	50	256
DN200	242	162	42	15	59.6	295	4 (8) X22	80	375
DN250	291	201	42	15	66	350	4 (12) X22	80	375

NO.	Name	Material
1	Body	SS304
2	Seat	PTFE
3	Disc	SS304
4	Stem	SS304
5	Pin	SS304
6	Sleeve	C95800
7	O-ring	EPDM
8	Bolt	Q235-A
9	Lever	CF8

Nominal Pressure	PN10	Design&MFG	GB/T12238
Shell Test	1.5Mpa	Face to Face	GB/T12221
Seal Test	1.0Mpa	End Standard	GB/T9113
Air Test	0.6Mpa	Inspection&Test	GB/T13927
Medium		Temperature	-23~+121°C

TURBINE BUTTERFLY VALVE PN16

DN	ØD1	ØD2	NXØB	L
DN32	Ø100	58	4XØ18	33
DN40	Ø110	73	4XØ18	42
DN50	Ø125	73	4XØ18	42
DN65	Ø145	85	4XØ18	44.7
DN80	Ø160	100	4(8)XØ18	45.2
DN100	Ø180	131	4(8)XØ18	52.1
DN125	Ø210	155	4(8)XØ18	54.4
DN150	Ø240	185	4(8)XØ22	55.8
DN200	Ø295	234	4(8)XØ22	60.6
DN250	Ø350	288	4(12)XØ22	65.6
DN300	Ø400	340	4(12)XØ22	76.9
DN350	Ø460	371	4(16)XØ22	76.5
DN400	Ø515	435	4(16)XØ26	86.5
DN450	Ø565	486	4(20)XØ26	105.6
DN500	Ø620	531	4(20)XØ26	131.8
DN600	Ø725	650	4(20)XØ30	152
DN700	Ø840	740	4(24)XM27	163
DN800	Ø950	845	4(24)XM30	188
DN900	Ø1050	943	4(28)XM30	203
DN1000	Ø1160	1049	4(28)XM33	216
DN1200	Ø1380	1260	4(32)XM36	276

NO.	Part Name	Material
1	Body	QT450/WCB/CF8
2	Seat	EPDM/NBR/PTFE
3	Disc	QT450/CF8
4	Stem	45#/410/304
5	Pin	45#/304
6	Sleeve	QSn4-3/recombination
7	O-ring	EPDM
8	Bolt	Q235-A
9	Key	45#
10	Worm Gear	HT200/QT450

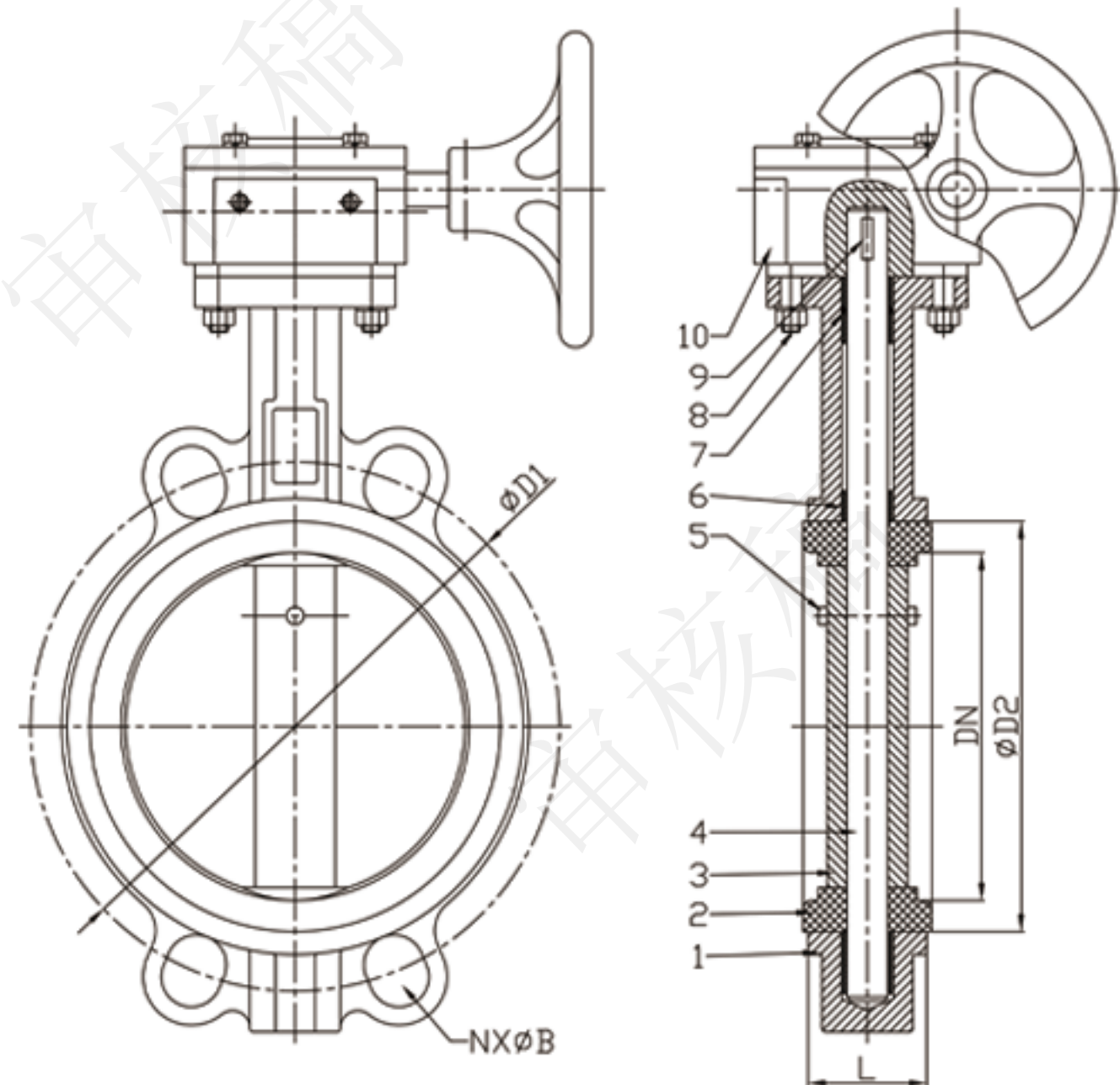

WAFER BUTTERFLY VALVE PN16

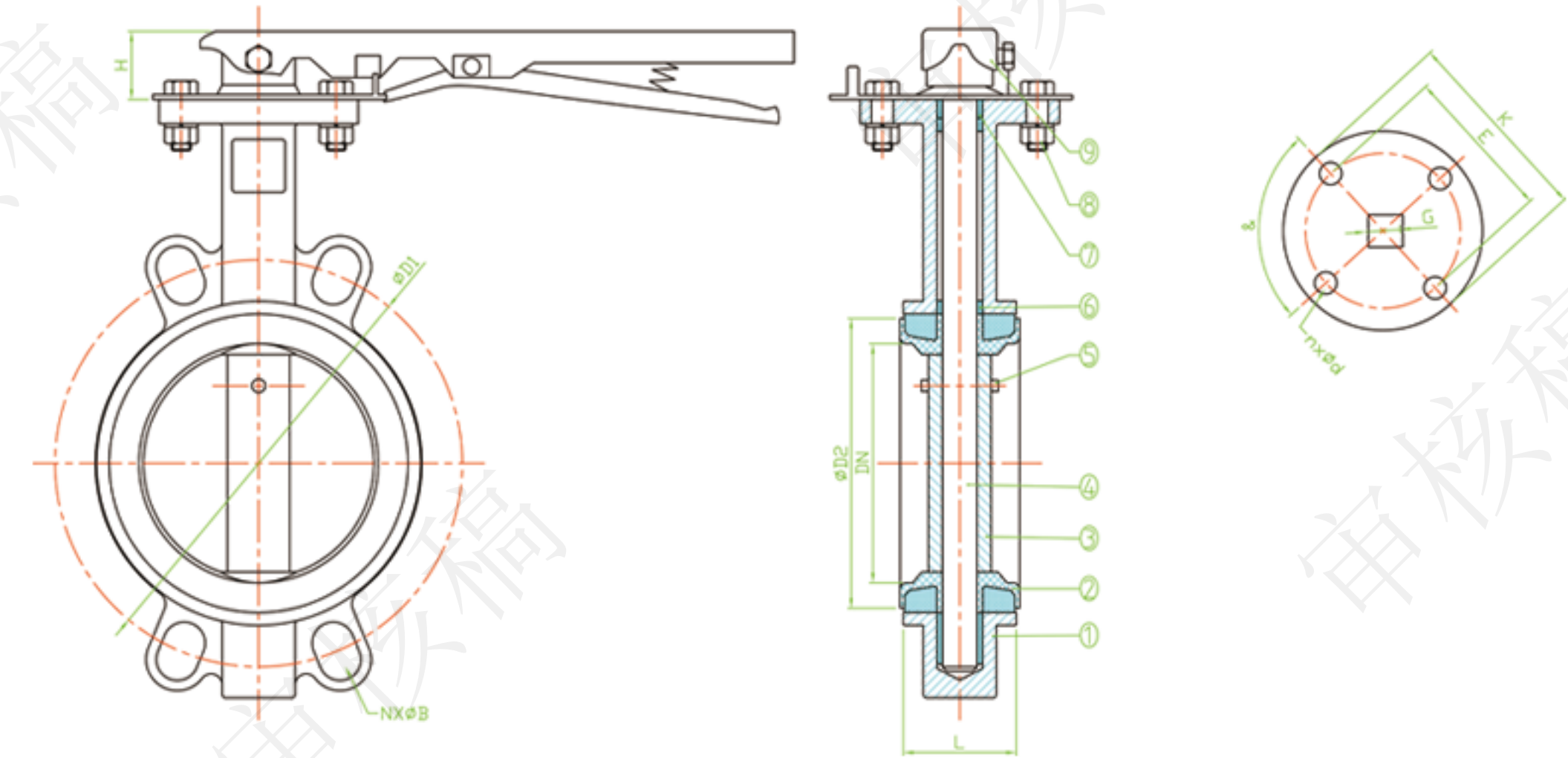

DN	ØD1	ØD2	NXØB	L	H	K	E	G	C	nxØd	&
DN50	125	73	4XØ18	42	28	70	57	9*9	3	4XØ7	45°
DN65	145	85	4XØ18	44.7	28	70	57	9*9	3	4XØ7	45°
DN80	160	100	4(8)XØ18	45.2	28	70	57	9*9	3	4XØ7	45°
DN100	180	131	4(8)XØ18	52.1	32	92	70	11*11	5	4XØ10	45°
DN125	210	155	4(8)XØ18	54.4	32	92	70	14*14	5	4XØ10	45°
DN150	240	185	4(8)XØ22	55.8	32	92	70	14*14	5	4XØ10	45°
DN200	295	234	4(8)XØ22	60.6	42	125	102	17*17	5	4XØ12	45°

NO.	Part Name	Material
1	Body	QT450/WCB/CF8
2	Seat	EPDM/NBR/PTFE
3	Disc	QT450/CF8
4	Stem	45#/410/304
5	Pin	45#/304
6	Sleeve	PTFE
7	O-ring	NBR
8	Bolt	SS201
9	Lever	Q235/QT450/CF8



WAFER BUTTERFLY VALVE PN16

DN	D1	D2	D	L
DN50	69	43.3	101	43
DN65	83	60.2	121	46
DN80	99	66.4	138	64
DN100	116.5	90.8	158	64
DN125	146	116.9	187	70
DN150	167	144.6	214	76
DN200	220	198.2	270	89
DN250	264	233.7	324	115
DN300	306	283.9	375	116
DN350	360	332.9	438	127
DN400	410	381	489	140
DN450	450	419.9	535	152
DN500	505	467.8	594	152
DN600	624	572.6	690	178

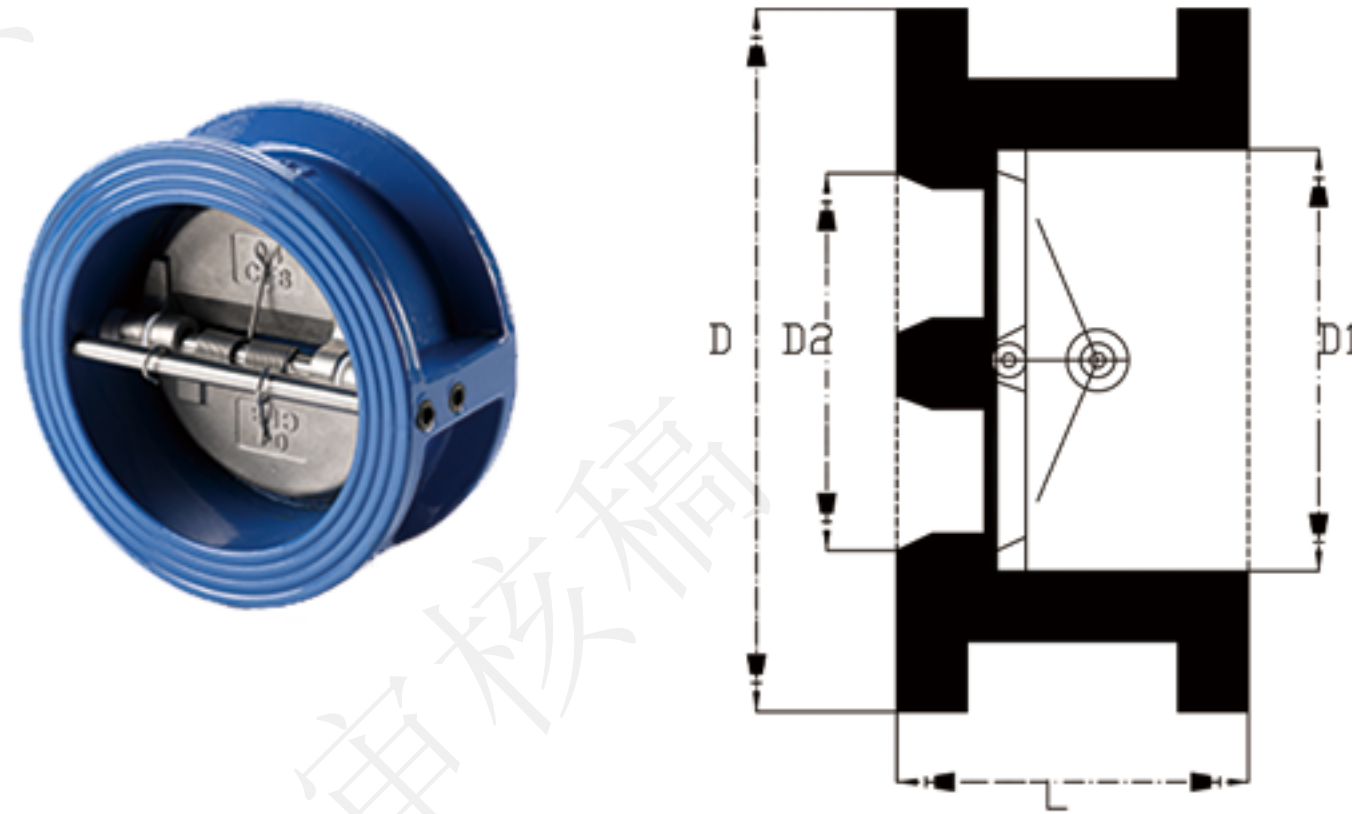

NO.	Part Name	Material
1	Body	QT450/WCB/CF8
2	Seat	EPDM/NBR
3	Disc	QT450/CF8
4	Stem	45#/410/304

SILENT CHECK VALVE PN16

Main Dimension(in/mm)							
DN	D	D1	D2	b	f	n-Ød	L
50	165	125	99	16	3	4-19	124
65	185	145	118	18	3	4-19	140
80	200	160	132	18	3	8-19	155
100	220	180	155	19	3	8-19	167
125	250	210	184	21	3	8-19	178
150	285	240	210	21	3	8-23	213
200	335	295	265	23	3	12-23	245
250	395	355	320	24	3	12-26	285
300	455	410	370	24	4	12-26	310

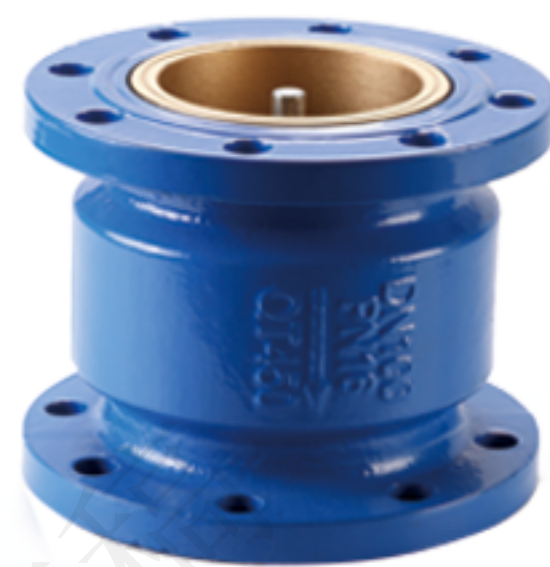

NO.	Name	Material
1	Body	Ductile Iron
2	Sealing Gasket	EPDM
3	Disc	Cast Iron
4	Stem	2Cr13
5	Spring	SS
6	Locating sleeve	WCB

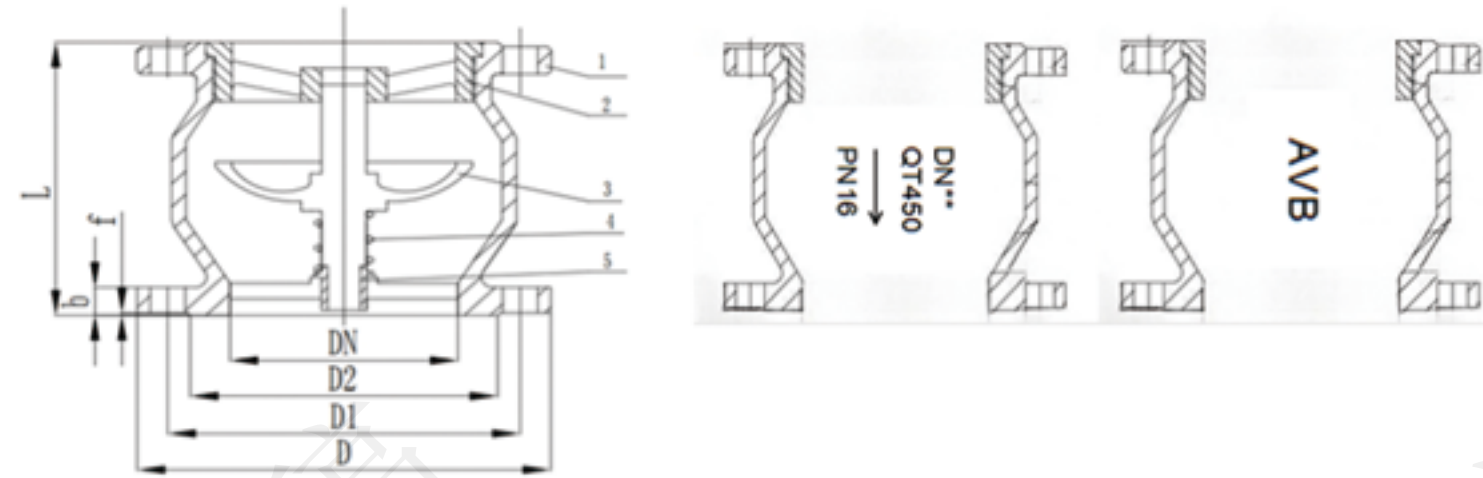

RUBBER CHECK VALVE PN16

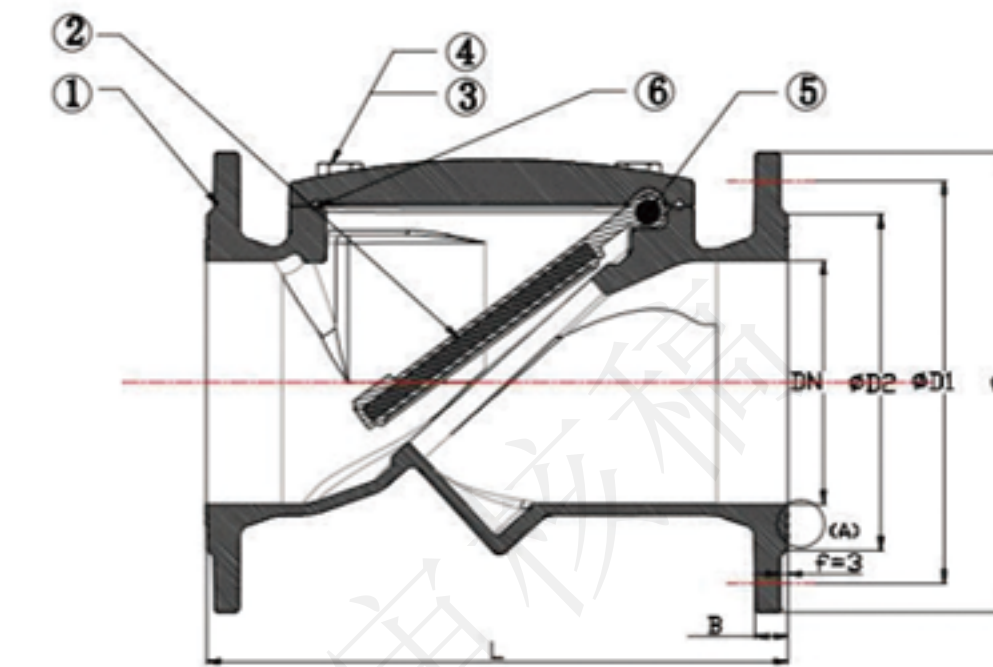

DN	L	D	D1	n-d	B
50	205	157	125	4*18	14
65	210	172	145	4*18	14
80	225	192	160	8*18	14
100	245	210	180	8*18	16
125	280	244	210	8*18	17
150	320	280	240	8*23	17
200	400	333	295	12*23	18
250	440	405	355	12*25	20
300	550	468	410	12*25	20

1	H44X-01	BODY	1	QT450-10
2	H44X-02	DISC	1	QT450+NBR
3	GB1229	BOLT	1	SS201
4	GB97	GASKET	X	SS201
5	H44X-03	PIN	1	/
6	H44X-04	GASKET	1	NBR

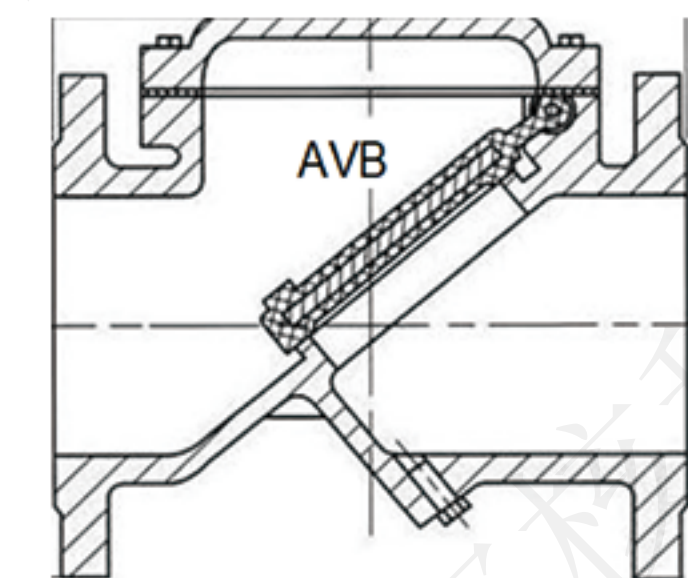
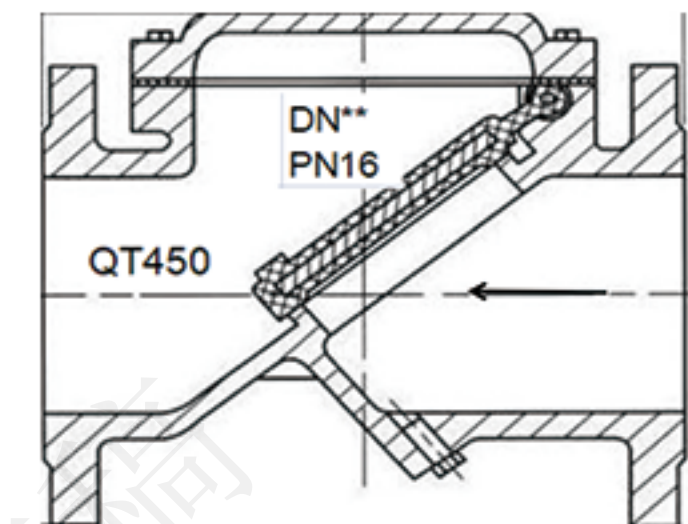

FOOT VALVE JIS10K

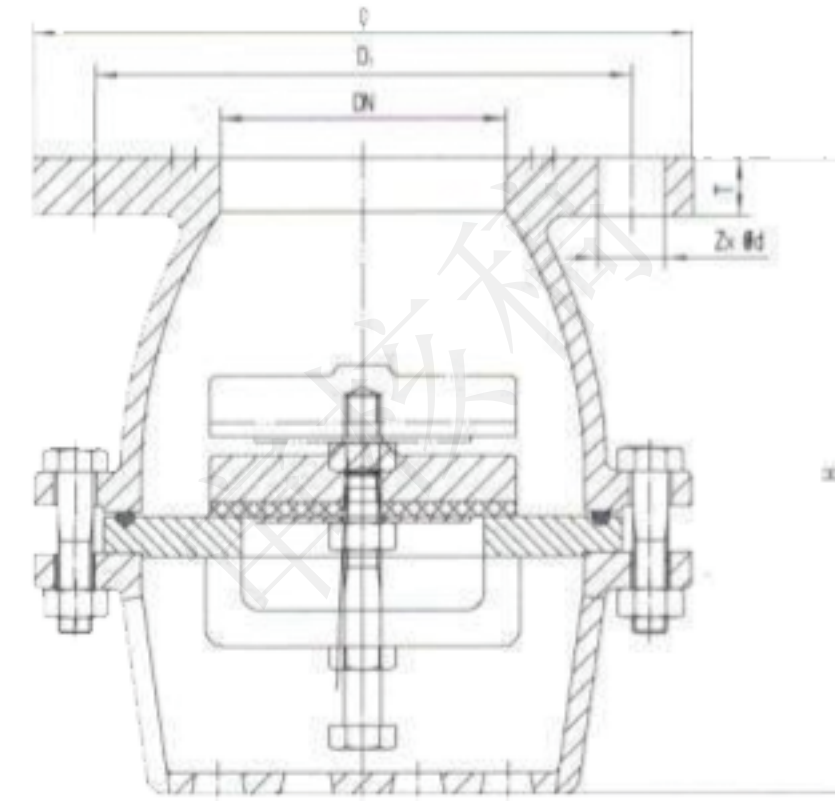

DN	D	D1	D	L
DN50	Ø155	Ø120	4*Ø19	16
DN65	Ø175	Ø140	4*Ø19	18
DN80	Ø185	Ø150	8*Ø19	18
DN100	Ø210	Ø175	8*Ø19	18
DN125	Ø250	Ø210	8*Ø23	20
DN150	Ø280	Ø240	8*Ø23	22
DN200	Ø330	Ø290	12*Ø23	22

Basic standard
• Flange end: KS B 1511/JIS
Feature
• PN:10K
• Shell test(water):2.1mpa
• Suitable temperature:≤80(°C)
• Suitable medium:water

Part Name	Material
Body	Cast Iron
Disc	Cast Iron
Disc Ring	NBR
O-ring	NBR

FOOT VALVE PN16

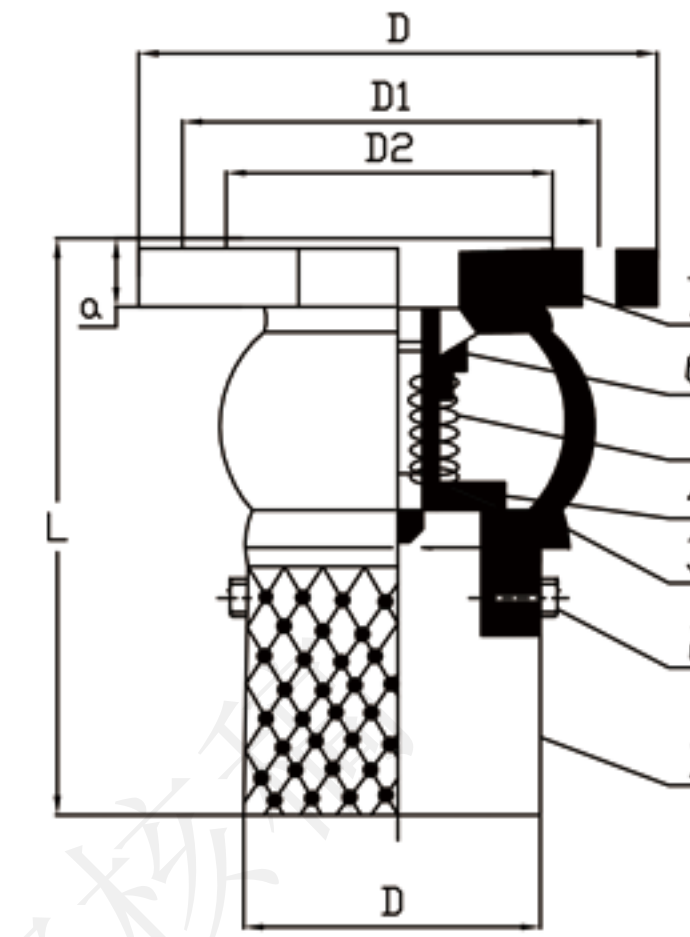

DN	L	D		D1		D2		α	n-Ød	
		pn10	pn16	PN10	PN16	PN10	PN16		PN10	PN16
50	164	165	165	125	125	99	99	19	4-Ø19	4-Ø19
65	217	185	185	145	145	118	118	19	4-Ø19	4-Ø19
80	240	200	200	160	160	132	132	19	8-Ø19	8-Ø19
100	275	220	220	180	180	156	156	19	8-Ø19	8-Ø19
125	307	250	250	210	210	184	184	19	8-Ø19	8-Ø19
150	343	285	285	240	240	211	211	19	8-Ø23	8-Ø23
200	470	340	340	295	295	266	266	22	8-Ø23	12-Ø23
250	560	395	405	350	355	319	319	24	12-Ø23	12-Ø27
300	610	445	460	400	410	370	370	26	12-Ø23	12-Ø27

Item	Part Name	Material
1	Screen	Stainless Steel
2	Bolts	SS304
3	Body	Ductile Iron
4	Disc	EPDM+Carbon Steel
5	Spring	Stainless Steel
6	Guide seat	Ductile Iron
7	Screw	C45E/1045

Y-STRAINER PN10/16

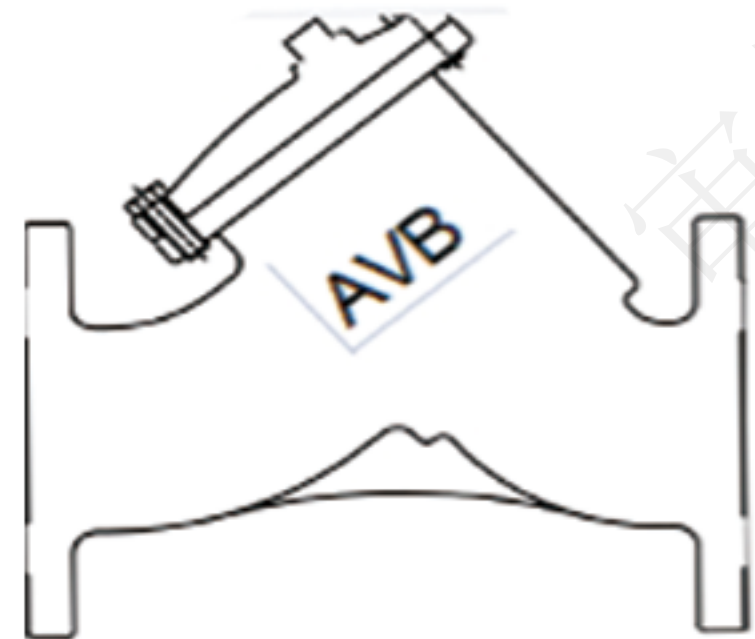
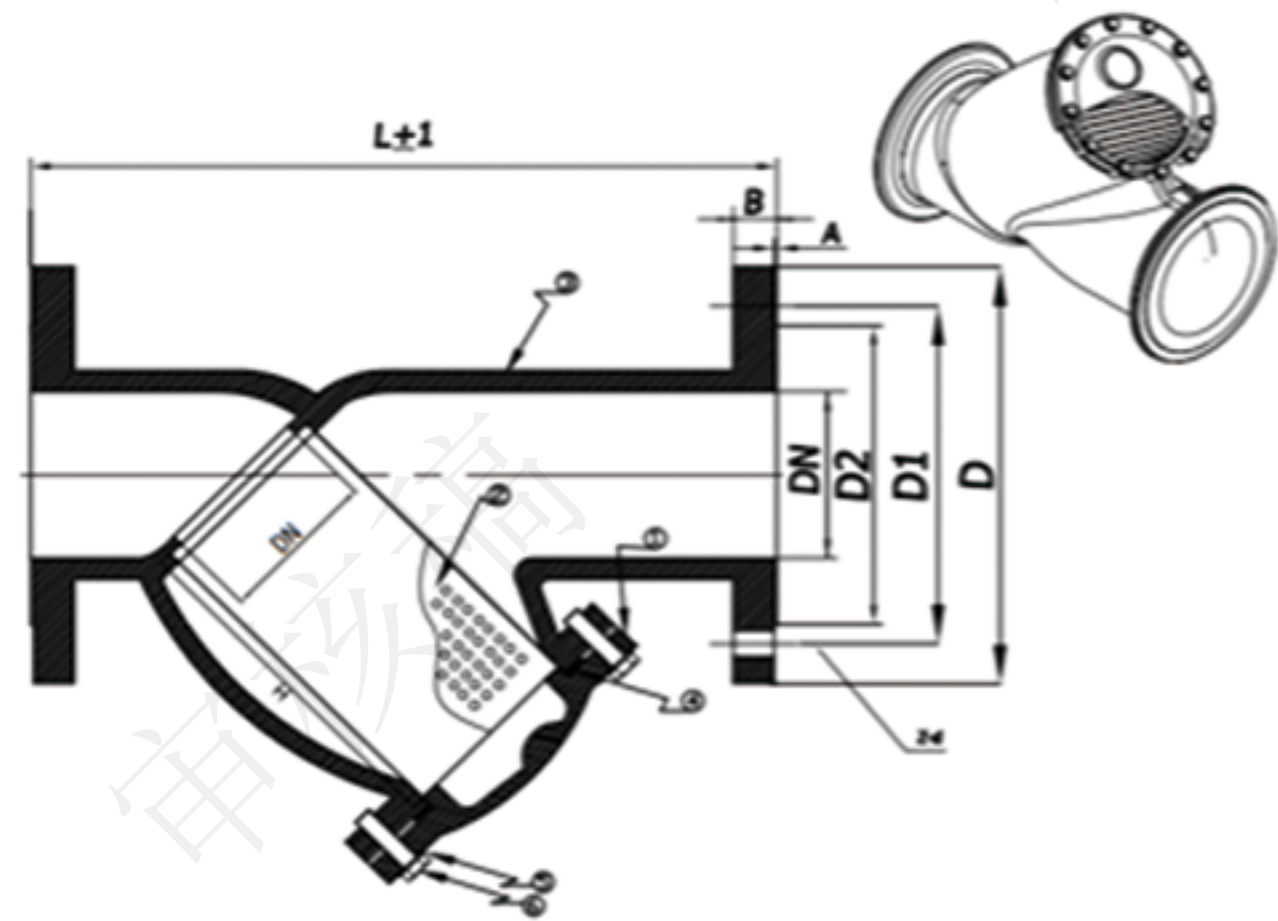

DN	L	D	D1	z-d	B
50	190	153	125	4*18	10.5
65	216	176	145	4*18	11.5
80	249	190	160	8*18	12
100	272	212	180	8*18	12
125	305	240	210	8*18	13
150	338	275	240	8*23	13
200	404	333	295	12*23	15

Item	Name	Material
1	Bonnet	GGG50
2	Screen	201
3	Body	GGG50
4	Bonnet Gasket	NBR
5	Gasket	201
6	Bolt	201

WET ALARM VALVE PN16

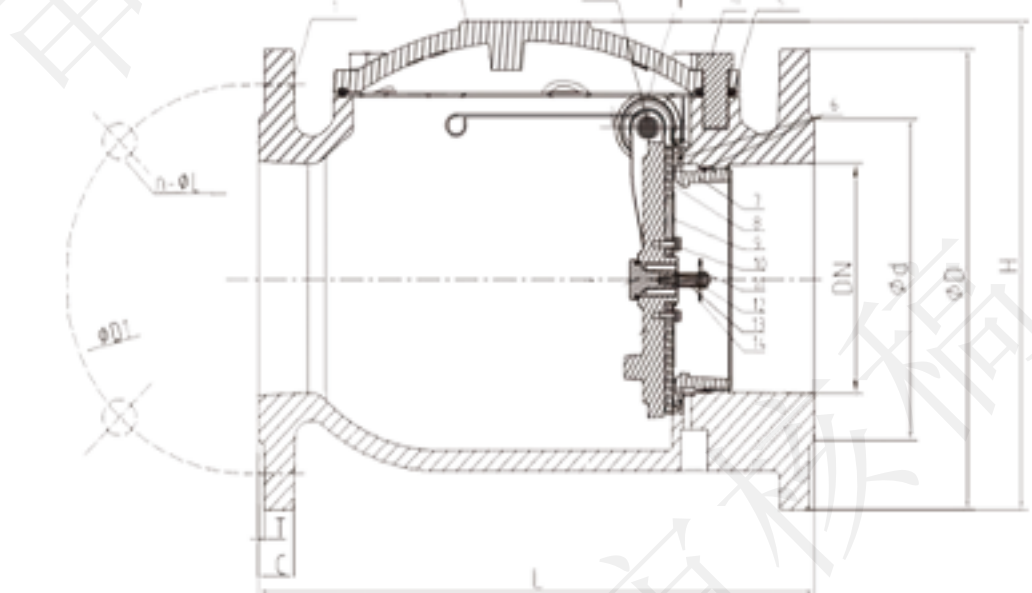

Part No	Part	Standard specification
1	Valve Body	EN-GJS-450-10
2	Bonnet	EN-GJS-450-10
3	Pin	Carton Steel Zinc Plated
4	Hex Bolt	Carton Steel Zinc Plated
5	Body Gasket	EPDM
6	O-Ring	NBR
7	Seat	EN-GJS-450-10
8	Gasket	EPDM
9	Disc Gland	Carton Steel Zinc Plated
10	Slotted Screw	Carton Steel Zinc Plated
11	Hexagonal Nut	Carton Steel Zinc Plated
12	Adjusting Screw	Carton Steel Zinc Plated
13	Core Tube	Carton Steel Zinc Plated
14	Core Board	Carton Steel Zinc Plated

DN		PN	Dimensions (mm)			
Inch	mm		L	D	D1	n-φ1
3"	ZSFZ80	16	214	200	160	8xφ18
4"	ZSFZ100		233	220	180	8xφ18
5"	ZSFZ125		243	250	210	8xφ18
6"	ZSFZ150		255	285	240	8xφ22
8"	ZSFZ200		291	340	295	12xφ22
10"	ZSFZ250		337	405	355	12xφ26

RUBBER JOINT FLANGE PN16

Size		Din Pn10/16				Jis10k		
IN	DN	L	D	D1	n-Ød	D	D1	n-Ød
1 1/4	32	95	140	100	4-18	135	100	4-19
1 1/2	40	95	150	110	4-18	140	105	4-19
2	50	105	165	125	4-18	155	120	4-19
2 1/2	65	115	185	145	4-18	175	140	4-19
3	80	135	200	160	8-18	185	150	8-19
4	100	150	220	180	8-18	210	175	8-19
5	125	165	250	210	8-18	250	210	8-23
6	150	180	285	240	8-23	280	240	8-23
8	200	210	340	295	8-23/12-23	330	290	12-23
10	250	230	395/405	350/355	12-23/12-27	400	355	12-25
12	300	245	445/460	400/410	12-23/12-27	445	400	16-25
14	350	255	505/520	460/470	16-23/16-27	490	445	16-25
16	400	255	565/580	515/525	16-27/16-30	560	510	16-27
18	450	255	615/640	565/585	20-27/20-30	620	565	20-27
20	500	255	670/715	620/650	20-27/20-33	675	620	20-27
24	600	260	780/840	725/770	20-30/20-36	795	730	24-33
28	700	260	895/910	840/840	24-30/24-36	715	840	24-33
32	800	260	1015/1025	950/950	24-33/24-39	817	950	28-33
36	900	260	1115/1125	1050/1050	28-33/28-39	919	1050	28-33
40	1000	260	1230/1255	1160/1170	28-36/28-42	1021	1160	28-39



Size		Din Pn10/16				Ansi Class150		
IN	DN	L	D	D1	n-Ød	D	D1	n-Ød
1 1/4	32	95	140	100	4-18	117.3	88.9	4-15.8
1 1/2	40	95	150	110	4-18	127	98.6	4-15.8
2	50	105	165	125	4-18	152.5	120.7	4-19.1
2 1/2	65	115	185	145	4-18	177.8	139.7	4-19.1
3	80	135	200	160	8-18	190.5	152.4	4-19.1
4	100	150	220	180	8-18	228.6	190.5	8-19.1
5	125	165	250	210	8-18	254	215.9	8-22.2
6	150	180	285	240	8-23	279.4	241.3	8-22.2
8	200	210	340	295	8-23/12-23	342.9	298.5	8-22.2
10	250	230	395/405	350/355	12-23/12-27	406.4	362	12-25.4
12	300	245	445/460	400/410	12-23/12-27	482.6	431.8	12-25.4
14	350	255	505/520	460/470	16-23/16-27	533.4	476.3	12-28.5
16	400	255	565/580	515/525	16-27/16-30	596.9	539.8	16-28.5
18	450	255	615/640	565/585	20-27/20-30	635	577.9	16-31.8
20	500	255	670/715	620/650	20-27/20-33	698.5	635	20-31.8
24	600	260	780/840	725/770	20-30/20-36	815	749.3	20-35.1
28	700	260	895/910	840/840	24-30/24-36	927.1	863.6	28-36
32	800	260	1015/1025	950/950	24-33/24-39	1060.4	977.9	28-41
36	900	260	1115/1125	1050/1050	28-33/28-39	1168.4	1055.8	32-41
40	1000	260	1230/1255	1160/1170	28-36/28-42	1289	1200.1	36-41

Type	Kxt
Working Pressure (Mpa)	1.6
Bursting Pressure (Mpa)	2.5
Angle Of Deflection	15°C
Applicable Temp	-15~115°C
Applicable Media	Water, Weak Acid, Alkali, Etc

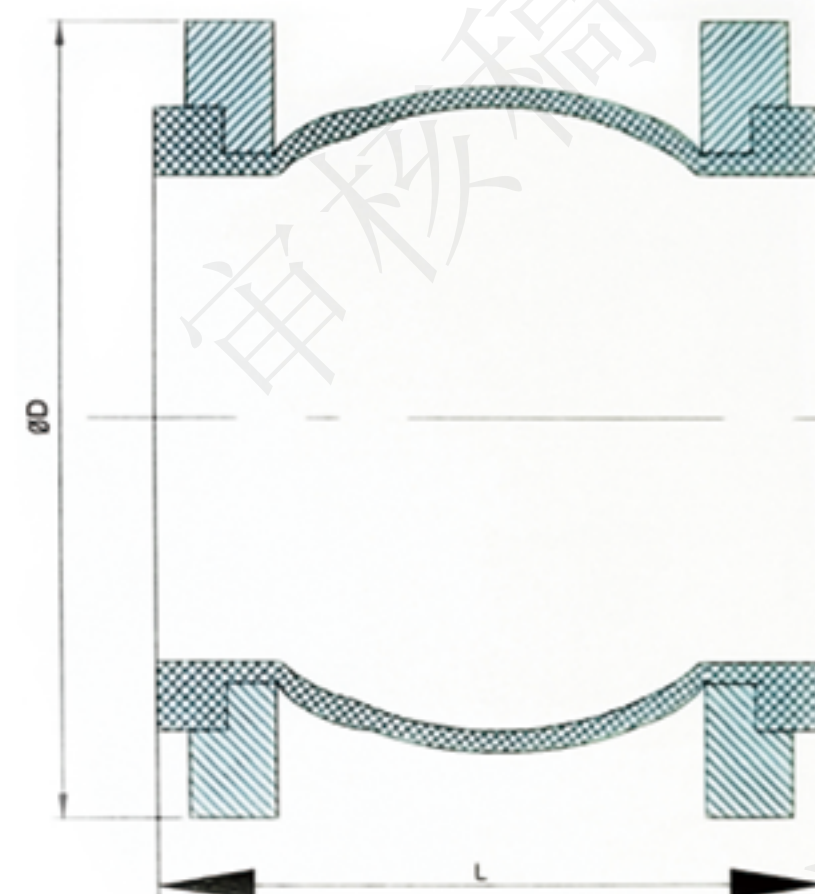
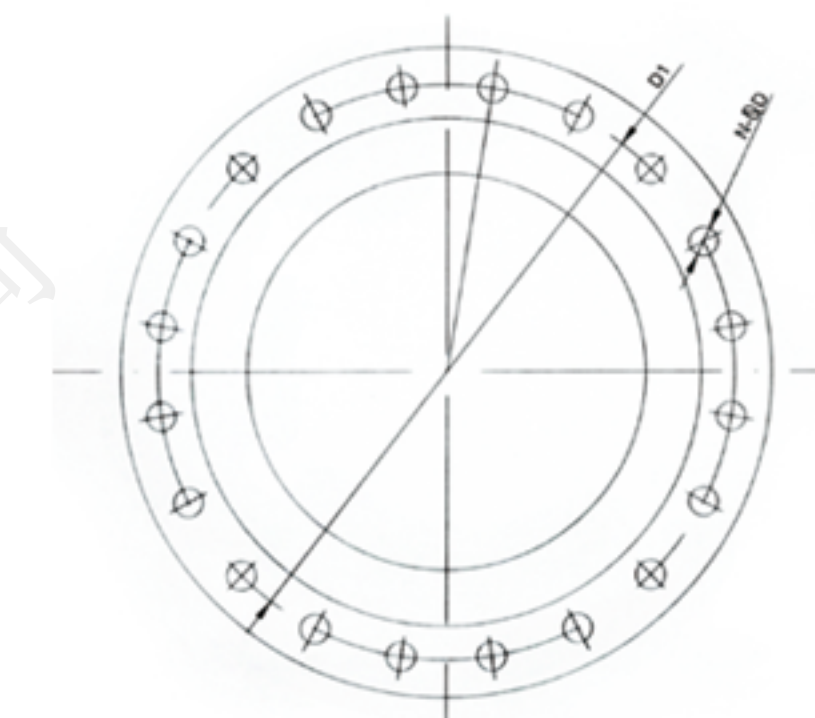

DIAPHRAGM DELUGE VALVE PN16



Part No	Part	Standard Specification
1	Body	D1
2	Seat	Brass
3	Connet fittings	WCB
4	Connet valve	Brass

DN		PN	Dimensions(mm)		
Inch	mm		Flange outer diameter	Pitch diameter of flange screw hole	Number of screw holes and hole diameter
2"	50	16	165	125	4xφ18
2 1/2"	65		185	145	4xφ18
3"	80		200	160	8xφ18
4"	100		220	180	8xφ18
5"	125		250	210	8xφ18
6"	150		285	240	8xφ22
8"	200		340	295	12xφ22
10"	250		405	355	12xφ26
12"	300		460	410	12xφ26

THREAD JOINT PN16

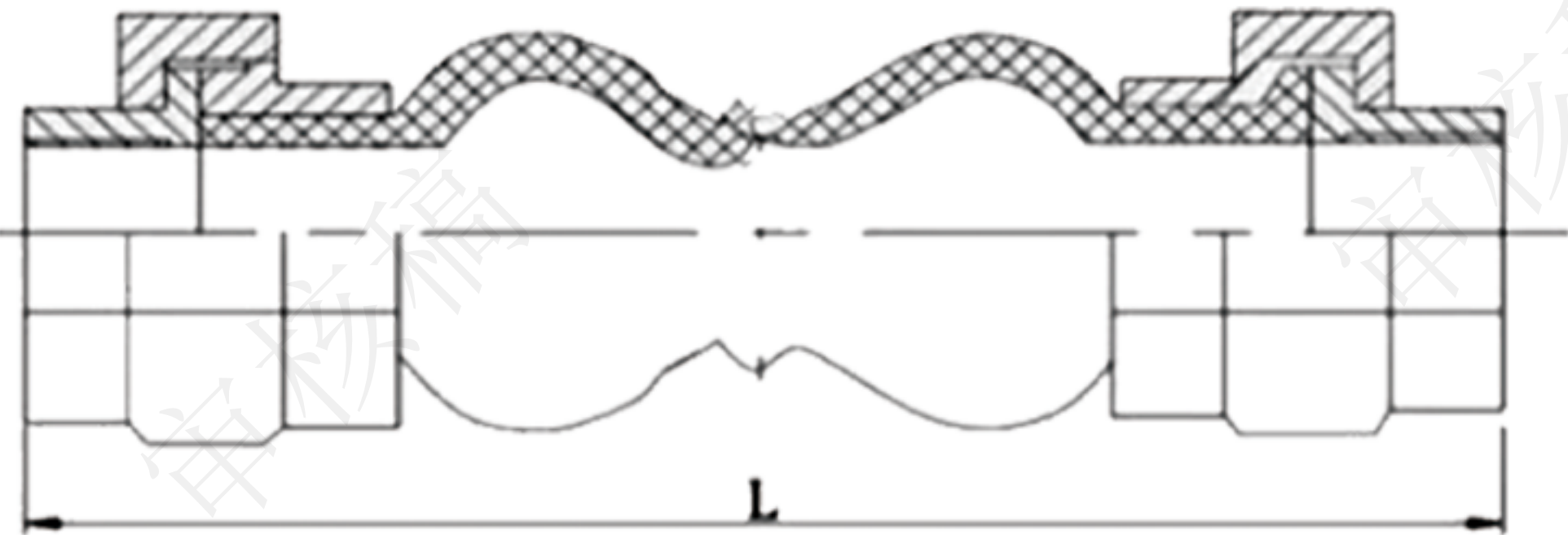

SIZE		L
IN	DN	
1/2	15	200
3/4	20	200
1	25	200
1 1/4	32	215
1 1/2	40	210
2	50	220
2 1/2	65	240
3	80	285



SIZE		L
IN	DN	
1/2	15	200
3/4	20	200
1	25	200
1 1/4	32	215
1 1/2	40	210
2	50	220
2 1/2	65	240
3	80	285

ITEM	PART	NAMEMATERIAL
1	Joint	Malleable iron
2	Liner	EPDM or NBR

Working Temp	-15~85℃
Working Pressure	1.6Mpa